

The Albany High Counselors Present...

An Introduction to Albany High School

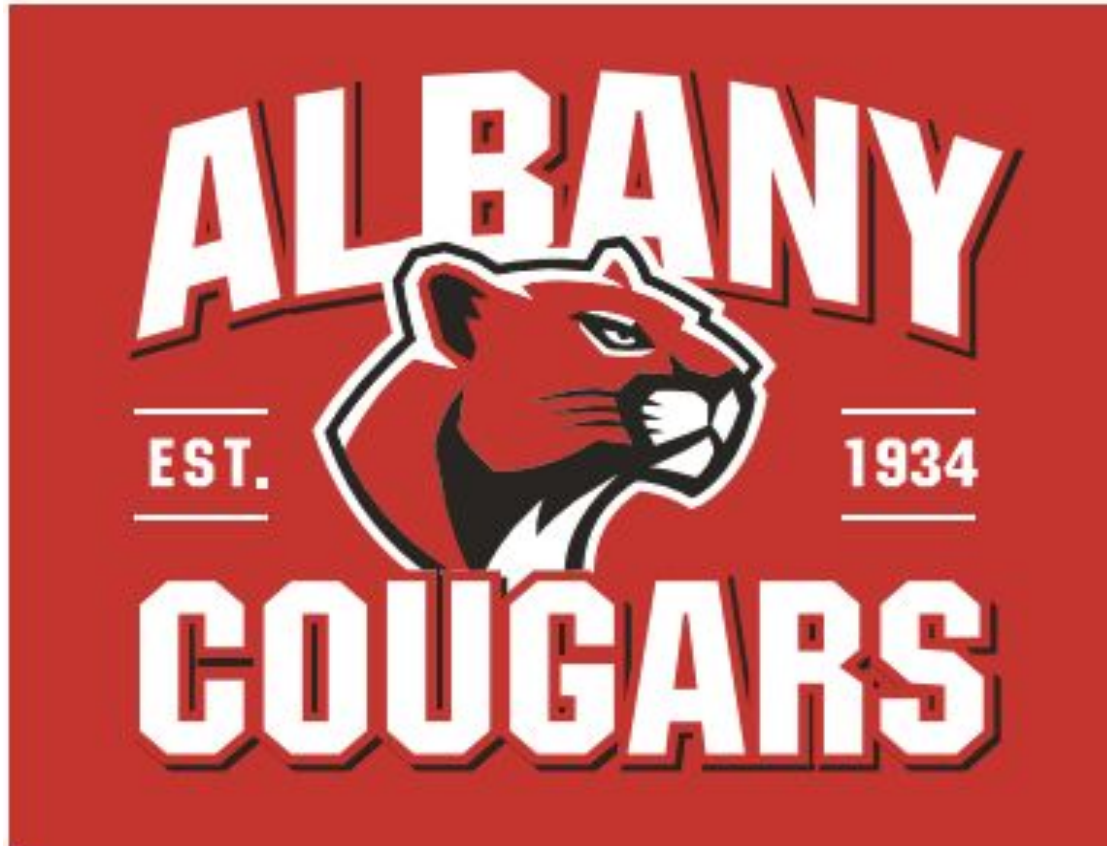

Presentation Overview

- Welcome and orientation to AHS
- School culture and activities
- Scheduling for rising 9th graders

Welcome to Albany High!

Places to know: our offices!

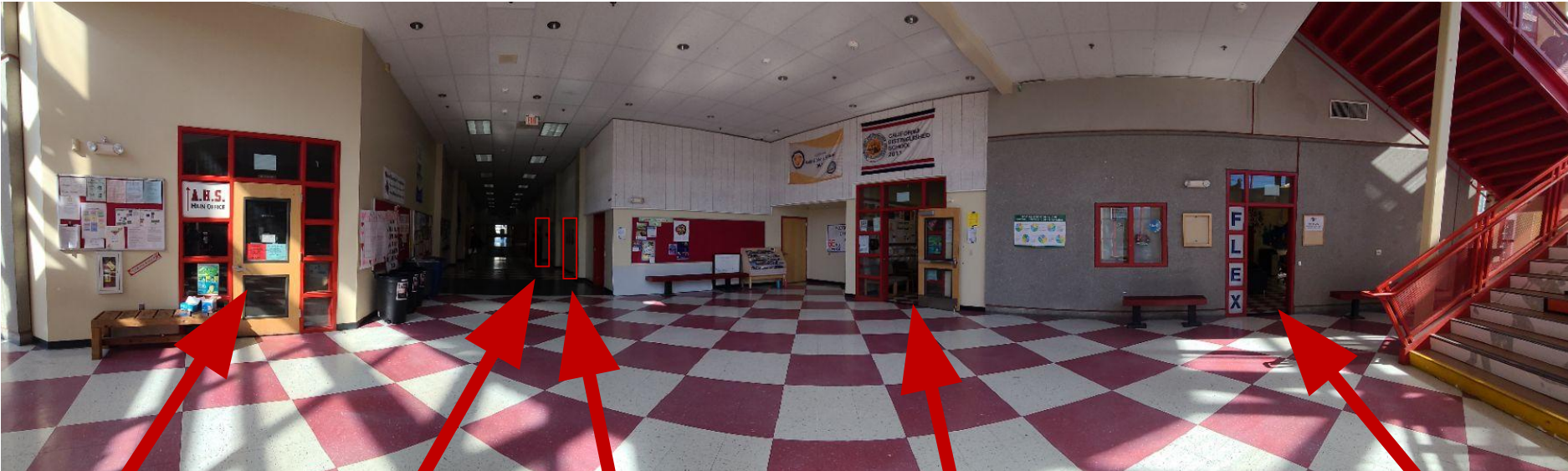

Main Office:
visitor check in,
teacher
mailboxes,
principal's office

Bookroom:
textbooks &
materials, club
charter and
finance, student
IDs

**Attendance
Office:**
tardy passes,
student sign-out,
asst. principals'
offices

**Counseling
Office:**
academic,
social/emotional,
college/career
services

Flex Office:
intervention and
support, school
nurse

AHS Block Schedule

Monday

50 minute periods

1st Period
8:30 - 9:20

2nd Period
9:25 - 10:15

3rd Period
10:30 - 11:20

4th Period
11:25 - 12:15

Lunch
12:15 - 1:00

5th Period
1:05 - 1:55

6th Period
2:00 - 2:50

7th Period
3:00 - 3:50

Block A (Tue/Thu)

95 minute periods

1st Period
8:30 - 10:05

3rd Period
10:20 - 11:55

Lunch
11:55 - 12:40

5th Period
12:45 - 2:20

7th Period
2:25 - 4:00

Block B (Wed/Fri)

95 minute periods

2nd Period
8:30 - 10:05

Advisory/Academy
10:10 - 10:50

4th Period
11:05 - 12:40

Lunch
12:40 - 1:25

6th Period
1:30 - 3:05

Balance Activities & Academics

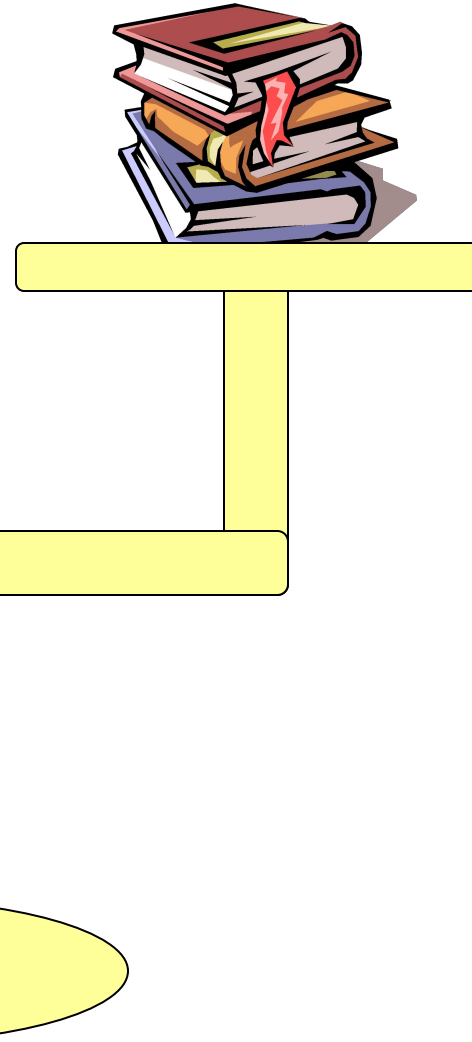

Get Involved!

- Clubs (Club Rush)
- Performing Arts
- Specialized Skills
- Athletics
- Youth Groups
- Volunteer Work
- Employment
- Student Govt.

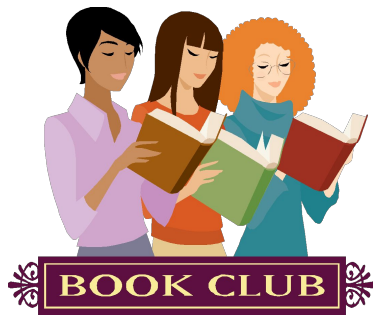

Athletics

FALL

Football

Girls Volleyball

Cross Country

Girls Tennis

Girls Golf

Girls Water Polo



WINTER

Basketball

Soccer

Wrestling



SPRING

Baseball

Softball

Track & Field

Swimming

Boys Golf

Boys Tennis

Boys Volleyball



9th Grade Athletic Eligibility

All athletes must have:

1. 2.0 grade point average (C) during the last semester of 8th grade

2. Medical clearance form on file

www.goalbanyathletics.org

3. All student-athletes must register and be cleared through www.familyid.com prior to participation.

Note: Athlete CANNOT step on the field until cleared by the athletic office

Support Services

- **Teachers** - first point of contact for concerns in a specific class
- **School Counselors** for personal, medical, or academic needs
- **Mental Health Counselors** for ongoing support
- **Assistant Principals:** discipline, attendance, student activities

Academic Support

- Tutoring: Math/Spanish hour
- Teacher contact
- Advisory Period
- Aeries



Communication

- **Parent Square** for daily and special updates, counseling newsletter, etc
- **School website** for bell schedule and events calendar, club list, resources and much more!
- **Student-centered**
 - Teachers often communicate directly with students and use Aeries and grade reports to report progress to families
 - Start working on self-advocacy now!

We love parent involvement!

- **PTSA - meets monthly**
- **Athletic Boosters**
- **Engagement Groups:** API-PEG, Disability Squad, Pride, BPAG, ELAC, Familias Latinas, Jewish Parent Engagement Group
- **Volunteering:** library, school-wide programs and planning, field trip chaperones

AHS Graduation Requirements

- **English:** 4 years
- **Math:** 2 years
- **Physical Ed.:** 2 years
- **Science:** 2 years
 - 1 year life
 - 1 year physical
- **Social Studies:** 3.5 years
 - Ethnic Studies (1 semester - 9th)
 - World History (10th)
 - U.S. History (11th)
 - US Gov/Econ (12th)
- **Fine Arts:** 1 year
- **Applied Arts:** 1 year

Plus **electives*** to total 220 credits

1 year = 2 semesters = 10 credits

*Electives include all classes beyond subject area requirement (e.g. 3rd year of math)

Credit-based system

Graduation Status		
Subject Area	Credit Required	
A - English	40.00	
B - Math	20.00	
C - Physical Education	20.00	
D - Life Science	10.00	
E - Physical Science	10.00	
F - Social Studies	10.00	
G - U.S. History	10.00	
H - U.S. Government	5.00	
I - Applied Arts	10.00	
J - Fine Arts	10.00	
K - Economics	5.00	
L - Ethnic Studies	5.00	
Z - Electives	65.00	

Grading

- **Quarter grades are like progress reports - and gradebooks do not reset each quarter**
- **Semester system: only semester grades appear on transcripts**
- **Grade reports are accessed through Aeries (separate from ongoing Gradebooks)**

9th Grade Program

Required 9th Grade Classes

- 1. English 1 or ELD**
- 2. Math 1 or Accelerated 1/2** – 8th grade AMS teacher recommendation *or* assessment for students new to AUSD
- 3. Physical Education (PE 1)**
- 4. Identity, Health and Society + Ethnic Studies - 1** semester each; may start with either class in fall and will look like 2 classes in course requests

Students in our Special Education Program will work directly with case managers to create a schedule that accurately reflects the Individualized Education Plan (IEP). English Learners/ELD will be placed by teacher recommendation.

Typical 9th Grade Schedule

- 1st Period – English
 - 2nd Period – Math (8th grade teacher rec)
 - 3rd Period - Physical Education
 - 4th Period - Identity Health & Society/Ethnic Studies
 - 5th Period - Biology / Elective*
 - 6th Period – World Lang / Elective*
-
- 7th Period – Elective* (***Optional***)
- *(Fine Arts, Applied Arts, General Elective)

9th Grade Program

9th Grade Electives

SCIENCE

Biology

WORLD LANGUAGE

French / Spanish / Mandarin

FINE ART/APPLIED ART

Visual and Performing Arts, Computer Science,
Engineering & Design, Journalism

GENERAL ELECTIVE

Global Current Events, Homework Lab, Service

Questions?



AHS Course Catalog

<http://ahs.ausdk12.org>

Click Students > Choosing Classes > Course Catalog



ALBANY HIGH SCHOOL

ABOUT CONTACT NEWS STUDENTS COLLEGE/CAREER COMMITTEES STAFF SEARCH

ACADEMIC HONESTY
ATHLETICS
ATTENDANCE POLICY
CHOOSING CLASSES
CLUBS
CODE OF CONDUCT
COMMONLY-USED FORMS
COUNSELING DEPARTMENT
COURSE PAGES
DISCIPLINE
FLEX
LEADERSHIP
LIBRARY
MENTAL HEALTH
P.E. UNIFORMS
TECH SUPPORT
TUTORING
VALEDICTORIAN/ SALUTATORIAN
WORK PERMITS

Welcome to Albany High School

QUICK LINKS

DAILY BULLETIN BELL SCHEDULES CALENDARS SIGN IN TO G-S

SIGN IN TO AERIES COLLEGE APPLICATIONS REPORT

Don't forget!
March 16-17 - Drop in AHS counselor help at lunch!
March 20 - Course selections are due in Aeries

Course Selection

Steps for Selecting Courses:

- **Review course catalog, select classes you are interested in**
- **Consider teacher recommendations from 8th grade (math, world language, ELD)**
- **Consider preference for 6 vs 7 class schedule** (reminder: you can graduate with plenty of credits taking 6 classes each year!)

Course Selection

- Students will use Aeries to choose classes. Course requests can only be made through the **student** portal
- All courses are year-long except Engineering & Design
- Alternate/2nd choices are required for all electives
- Schedule changes for compelling reasons may only be made during the first week of school
- Please refer to the course lists and instructions posted on the AHS website
- Course selections are due **Monday, March 20**

Course Selection Instructions

- Log into your student Aeries account
- Switch to your Pre-Enrolled Record in Aeries: hover over the student's name and click on the Pre-Enrolled record. It will say [Pre-Enrolled] Grd 9 next to your name

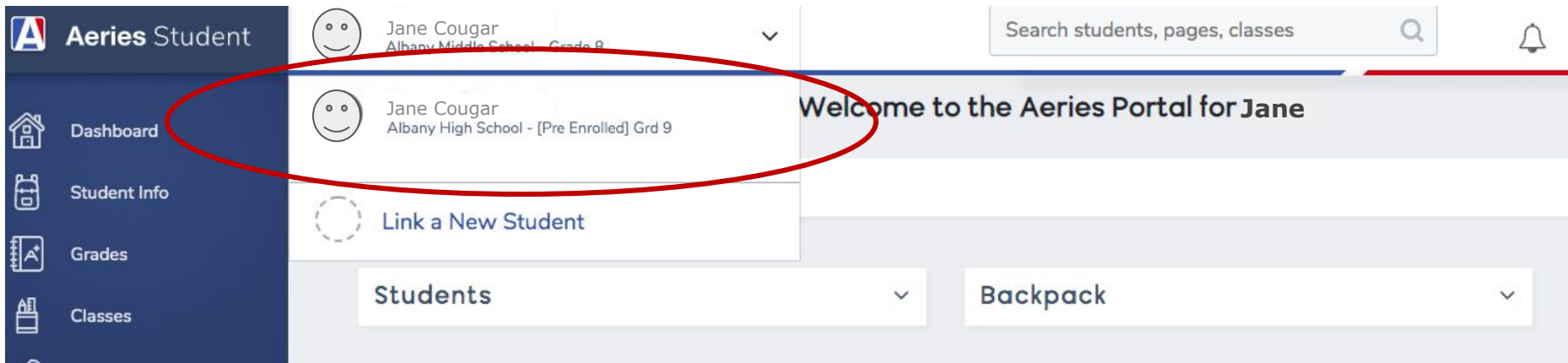

Course Selection Instructions

Go to Classes > Course Requests Entry

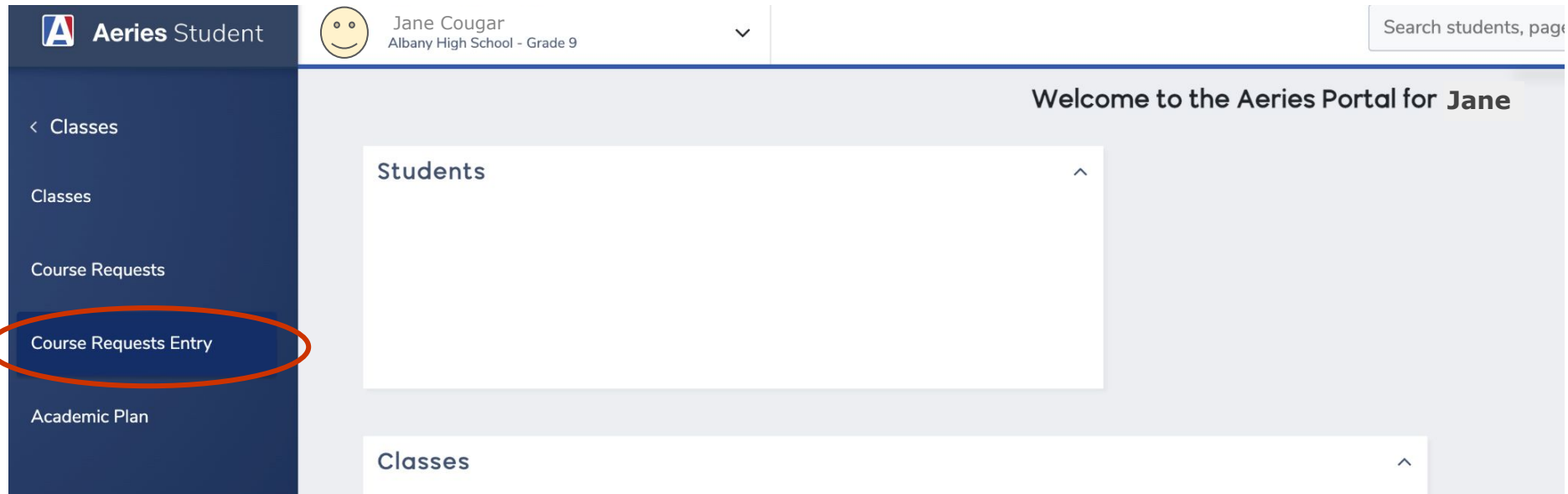

The screenshot shows the Aeries Student portal interface. On the left is a dark blue sidebar with navigation links: '< Classes', 'Classes', 'Course Requests', 'Course Requests Entry' (circled in red), and 'Academic Plan'. The top header area includes the 'Aeries Student' logo, a user profile for 'Jane Cougar' (Albany High School - Grade 9) with a smiley face icon and a dropdown arrow, and a search bar labeled 'Search students, page'. The main content area has a light gray background with a welcome message: 'Welcome to the Aeries Portal for Jane'. Below this, there are two white panels: 'Students' with an upward arrow and 'Classes' with an upward arrow.



Course Selection Instructions

- Set Subject Area to **Show All Courses**
- Hit **Search** to display list (may be more than one page)
- Find classes alphabetically by name

All Course Requests must be approved by appropriate school personnel.

Scheduling for grade: 10

Course Requests

Primary Course Requests

Subject Area Alternate Requests

English

Math

Physical Education

Life Science

Physical Science

Social Studies

U.S. History

U.S. Government

Applied Arts

Fine Arts

Economics

Electives

Alternate Course Requests Priority Sort

You have no Alternate Course Requests

Filter Courses

Name or Nbr:

Sbj Area: Show All Courses Search Remove Filter

<< Prev 1 2 Next >> Courses 1 through 54 of 65

Click A Course To Request or for Info

Accel Math 2-3 (30CP3A)	Eld 4 (10CP29)	Mandarin 3 (40CP32)
Adv Dance 2 (61CP21)	ELD Lab (100029)	Mandarin 4 (40CP33)
Advanced Art (60CP03)	English 2 (10CP02)	Math 2 (30CP31)
Advanced Guitar (61CP17)	Engineer&Design 1 (70CP07)	Math 2 Plus (30CP32)
Basic Guitar (61CP12)	Engineer&Design 2 (70CP08)	Math Int 2 (300002)
Biology (50CP02)	Ethnic Studies (20CP25)	P E -2 (800002)
Business Mgt (300013)	Found Art 2D (600003)	Physics (50CP08)
Cham Sings (61CP07)	Found Art: 3D (600011)	Psychology (20CP20)
Chemistry (50CP06)	French 1 (40CP08)	Rop Comgraphic Art (70ROP8)
Computer Sci (70CP01)	French 2 (40CP09)	Service (90SRVC)
Concert Choir (61CP03)	French 3 (40CP22)	Shelt Math 2 (00SHM2)
Culinary Arts (710003)	Homework Lab (90HW00)	Shelt Math 2+ (05HM2P)
Dance 1 (61CP14)	Jazz Band (610008)	Shelt Wrld His (20CP13)



Course Selection Instructions

- Available classes will show on the right; selected courses will move to the left column
- Be sure to select alternates for all elective courses

Primary Course Requests

Subject Area

English

Math

Physical Education

Life Science

Physical Science

Social Studies

U.S. History

U.S. Government

Applied Arts

Fine Arts

Economics

Electives

Alternate Requests

English 2 (10CP02)

Math 2 (30CP31)

P E -2 (800002)

World History (20CP01)

Manage

Manage

Manage

Manage

Alternate Course Requests

Priority Sort

You have no Alternate Course Requests

Filter Courses

Name or Nbr:

Sbj Area: Show All Courses

Search

Remove Filter

<< Prev 1 2 Next >> Courses 1 through 54 of 65

Click A Course To Request or ? for Info

Accel Math 2-3 (30CP3A)

Eld 4 (10CP29)

Mandarin 3 (40CP32)

Adv Dance 2 (61CP21)

ELD Lab (100029)

Mandarin 4 (40CP33)

Advanced Art (60CP03)

English 2 (10CP02)

Math 2 (30CP31)

Advanced Guitar (61CP17)

Engineer&Desgn 1 (70CP07)

Math 2 Plus (30CP32)

Basic Guitar (61CP12)

Engineer&Desgn 2 (70CP08)

Math Int 2 (300002)

Biology (50CP02)

Ethnic Studies (20CP25)

P E -2 (800002)

Business Mgt (300013)

Found Art 2D (600003)

Physics (50CP08)

Cham Sings (61CP07)

Found Art: 3D (600011)

Psychology (20CP20)

Chemistry (50CP06)

French 1 (40CP08)

Rop Comgraphic Art (70ROP8)

Computer Sci (70CP01)

French 2 (40CP09)

Service (90SRVC)

Concert Choir (61CP03)

French 3 (40CP22)

Shelt Math 2 (00SHM2)

Culinary Arts (710003)

Homework Lab (90HW00)

Shelt Math 2+ (0SHM2P)

Dance 1 (61CP14)

Jazz Band (610008)

Shelt Wrld His (20CP13)

The logo for Fleary High School Cougars, featuring a red and white circular emblem with a cougar head and the text "FLEARY HIGH SCHOOL" and "COUGARS".

Course Selection Instructions

Alternate Course Requests

Primary Course Requests

Subject Area

English	English 2 (10CP02)	Manage
Math	Math 2 (30CP31) (30CP31)	Manage
Physical Education	P E -2 (800002) (800002)	
Life Science		
Physical Science	Chemistry (50CP06)	
Social Studies	World History (20CP01)	
U.S. History		
U.S. Government		
Applied Arts		
Fine Arts		
Economics		
Electives	Ethnic Studies (20CP25)	1 Manage

Alternate Course Requests

Found Art 2D (600003)

Priority Sort

Filter Courses

Name or Nbr: Sbj Area: Show All Courses

<< Prev 1 2 Next >> Courses 1 through 54 of 65

Click A Course To Request or ? for Info

Ethnic Studies (20CP25)

Subject Area #1: Electives

Type: Academic Course

UC Area: Electives

CSU Area: Electives

Request Primary Request Alternate

Click "Manage" to associate primary and alternate choices



Course Selection Instructions

- Course requests will save automatically.
- Once the Aeries window closes you will not be able to edit choices.

The screenshot displays the Aeries Course Selection interface. It features a 'Primary Course Requests' section with a list of subject areas and corresponding course options. A large red circle highlights this section. Below it is the 'Alternate Course Requests' section, which is also highlighted by a smaller red circle. The interface includes a 'Subject Area' dropdown menu, a list of course requests with 'Manage' buttons, and a 'Priority Sort' button. The right side of the interface shows a list of additional course options.

Subject Area	Course Request	Manage
English	English 2 (10CP02)	Manage
Math	Math 2 (30CP31)	Manage
Physical Education	P E -2 (800002)	Manage
Life Science		
Physical Science	Chemistry (50CP06)	Manage
Social Studies	World History (20CP01)	Manage
U.S. History		
U.S. Government		
Applied Arts		
Fine Arts		
Economics		
Electives	Ethnic Studies (20CP25)	Manage

Alternate Course Requests

Course Request	Priority Sort
Found Art 2D (600003)	



Students

[ACADEMIC HONESTY](#)
[ATHLETICS](#)
[ATTENDANCE POLICY](#)
[CHOOSING CLASSES](#)
[CLUBS](#)
[CODE OF CONDUCT](#)
[COMMONLY-USED FORMS](#)
[COUNSELING DEPARTMENT](#)
[COURSE PAGES](#)
[DISCIPLINE](#)
[FLEX](#)
[LEADERSHIP](#)
[LIBRARY](#)
[MENTAL HEALTH](#)

How to Select Courses @ AHS

WHAT YOU NEED

- Your transcript. Use this to check that you are meeting all graduation requirements.
- Albany High School Course Catalog (below). Use this to learn about course options and to check prerequisites and learn what requirements each course meets.
- Albany High "A-G" List (below). Use this to check which courses meet college eligibility requirements.

GUIDELINES

- In order to plan the most meaningful program for next year, discuss your choices with your parents, teachers before submitting your selection sheet. Consider time commitments, activities and interests outside of school. Consider optional courses for your most high-school plans. To be 4-year-college eligible, you must complete at least 5 academic classes per year. You must complete 10 classes used to meet college eligibility requirements. Students are limited to one class per subject in Arts and Social Sciences.

AHS COURSE CATALOG

The Course Catalog contains descriptions of all courses offered at Albany High School as well as requirements and prerequisites. Students should refer to the Course Catalog when selecting courses for the following school year.

COURSE LISTS

These documents show every course (without descriptions) offered at each grade level. They are updated each spring for the following-year's schedule.

[9th Grade](#) [10th Grade](#)
[11th Grade](#) [12th Grade](#)

PROGRAM-SPECIFIC PRESENTATIONS

Albany High School course selection sheet for 2022-23 Courses open to NINTH grade students

In addition to **English/ELD, P.E., Identity Health and Society, and Math**, each student must select a minimum of two courses for a six period day. A seventh period is optional. It is extremely important to list alternates for each elective. If alternates are not listed and your first choice cannot be accommodated, your counselor will choose your course for you. Please make your selections carefully. With few exceptions, changes will NOT be possible.

ELECTIVE COURSE OFFERINGS ARE CONTINGENT UPON STUDENT SIGN-UPS

Required courses:

ENGLISH <ul style="list-style-type: none"> English 1 	HEALTH <ul style="list-style-type: none"> Identity, Health and Society (IHS) 	PHYSICAL EDUCATION <ul style="list-style-type: none"> PE 1 	MATH <ul style="list-style-type: none"> Math 1* Accelerated Math ½*
Courses listed below are considered electives:			
LIFE SCIENCE <ul style="list-style-type: none"> Biology 	APPLIED ARTS <ul style="list-style-type: none"> Engineering & Design Principles 1 & 2 ** Computer Science 	WORLD LANGUAGES <ul style="list-style-type: none"> French 1 French 2* Spanish 1 Spanish 2* Spanish for Native Speakers Mandarin 1 Mandarin 2* 	FINE ARTS <ul style="list-style-type: none"> Foundation Art: 2D Foundation Art: 3D Symphonic Band String Orchestra Basic Guitar Advanced Guitar* Concert Choir Treble Chamber Ensemble* Dance 1 Dance 2*/Adv. Dance 2*
GENERAL ELECTIVE <ul style="list-style-type: none"> Business Management Service* Homework Lab 			

Courses marked with (*) require teacher recommendations.
Semester-long courses with (**) can only be chosen as a 7th course option.

Math, World Language, and English Language Development (ELD) classes are determined by teacher recommendation. The AHS counselors will work with the teachers in these departments to place students in the appropriate level course. No signatures are needed on the course request form in these subjects. For students in our Special Education Program, you will work directly with your Case Manager to create a schedule that accurately reflects your Individualized Education Plan (IEP).

Some advanced level Fine Arts courses are open to 9th graders only after auditions. You may sign up for one of these courses, but be sure to list at least one alternate choice that does not require an audition.

- For Treble Chamber Ensemble, please email Ms. Huizinga at khuizinga@ausdk12.org.

**Find course lists
on our website!**

Counseling Caseloads

Michelle Aselstine (A - Cho)

Becca Burns (Chr – Kn)

Tedra Grogans (Ko– Re)

M.E. Durell (Rh - Z)

Diane Peterson (MacGregor)

Ce Parrott – Office Secretary

We are excited to work with you and your students next year!

In the interest of providing the best possible support to our current students, we'll be working with AMS staff to make sure any questions get addressed through your child's current site.



***Opening Day
& Freshman Orientation***

**Week before school starts
(Thursday, August 10th)**

Class Schedules Available

Purchase Yearbooks

PE uniforms

Campus Tours (8/10 and 8/11, 2:00 to 4:00 pm)

First Day of School

Monday, August 14, 2023

Questions?

